



SURMANG CLINIC

Enter address here

10 21 13
SITE PLAN - GENERAL INFO

4435 REGISTERED ARCHITECT
RALPH W. ALLEN
STATE OF WASHINGTON

© 2009 GRACE Architects PLLC
Any reproduction or use of this material is strictly prohibited
except as authorized in writing by the copyright holder.

- rev-1 - date - topic
- rev-2 - date - topic
- rev-3 - date - topic
- rev-4 - date - topic
- rev-5 - date - topic
- rev-6 - date - topic

GRACE ARCHITECTS PLLC
7310 15TH AVE NW
Seattle, Washington, 98117
ph 206 957 9900
fax 206 692 3159
rwallen@gracearchitectspllc.com

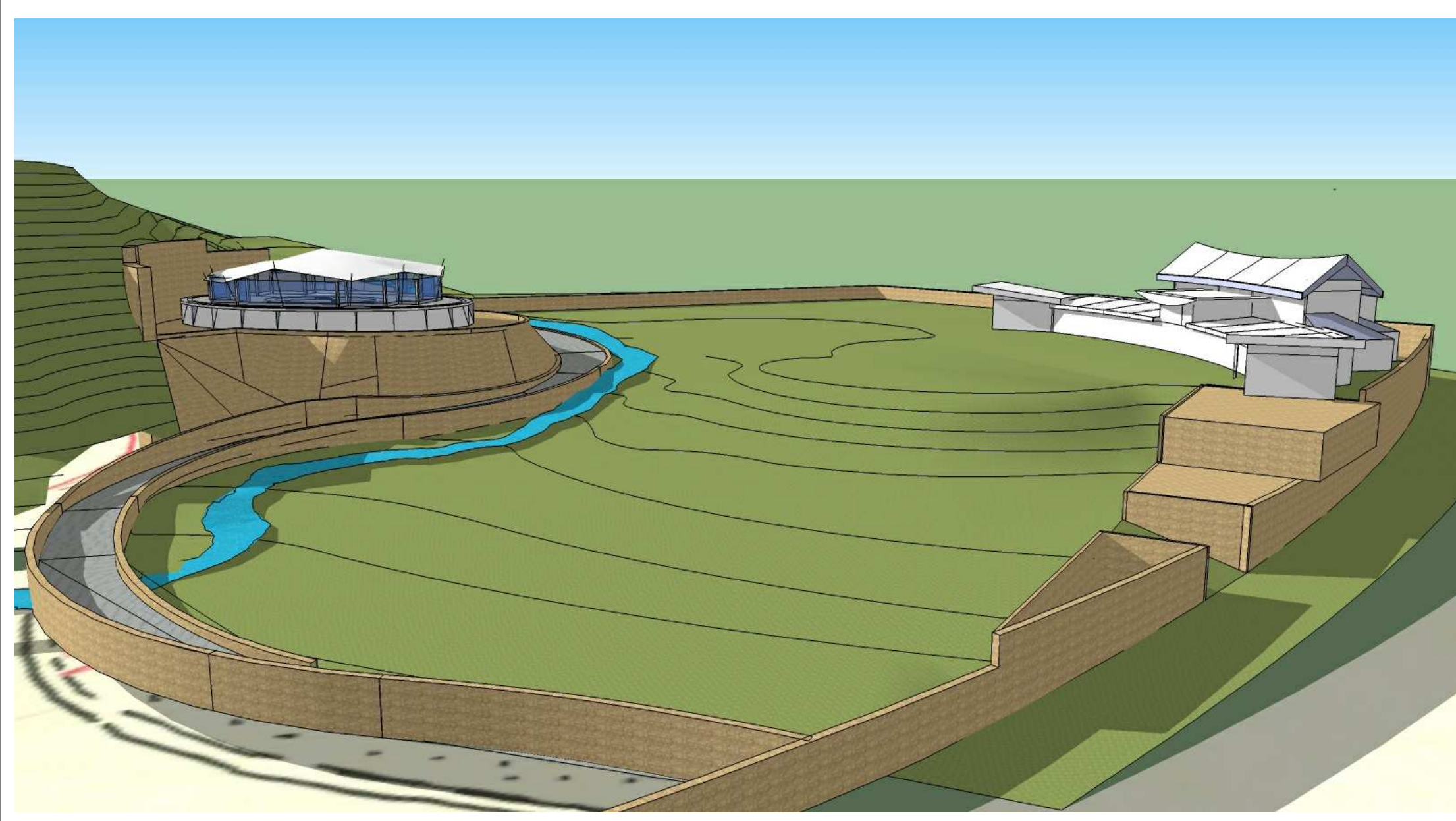
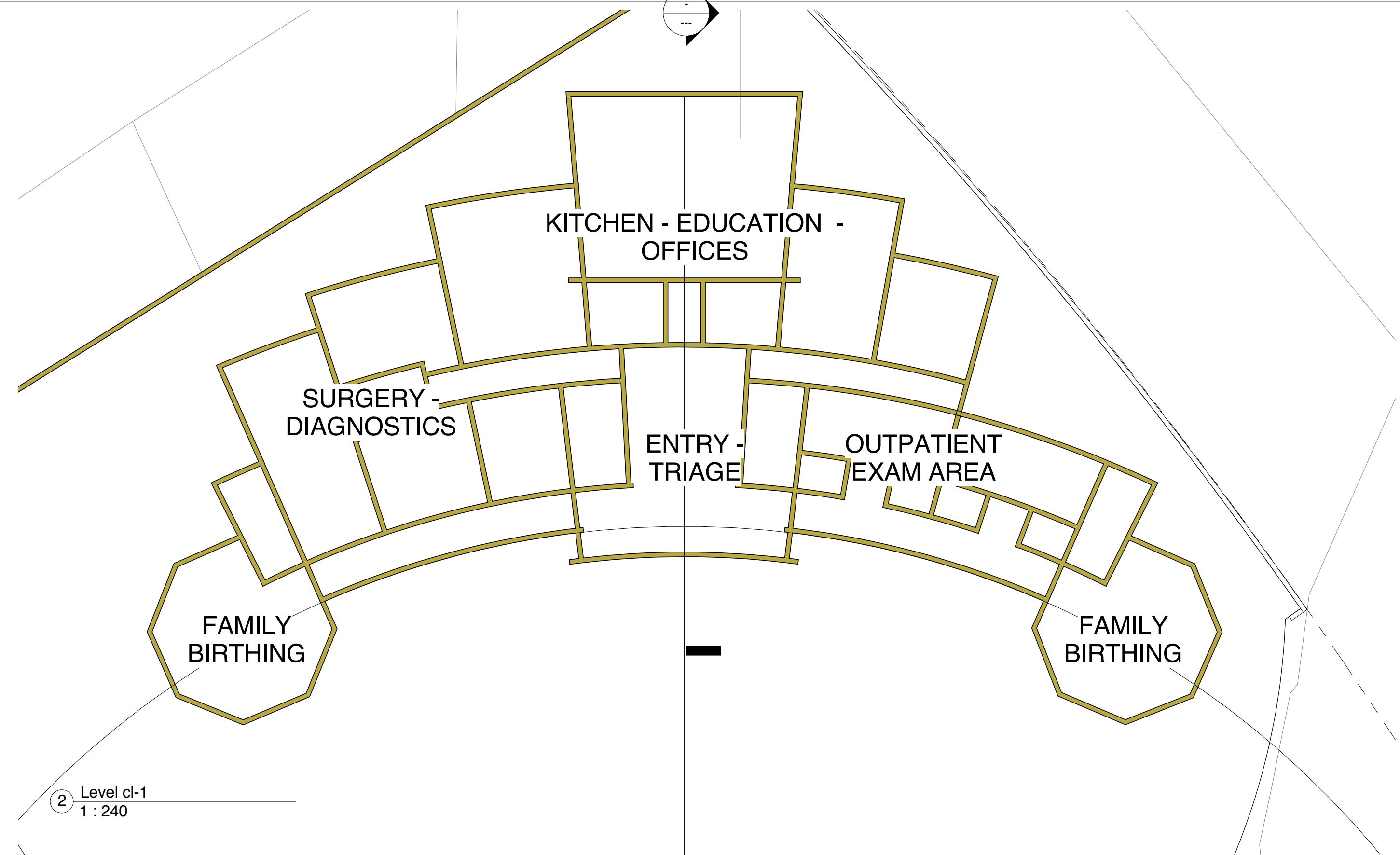

NEW CAMPUS OVERVIEW:
7 ACRE SOUTH FACING SITE WITH YEAR ROUND RIVER RUNNING ALONG THE TOE OF ADJACENT MOUNTAIN / SEASONAL SPRING WITH VERY CLEAR WATER

NEW SURMANG CLINIC FACILITY
ECO-TOURISM LODGE
PHYSICIAN HOUSING

ALTERNATE ENERGY SOURCES UNDER CONSIDERATION
SOLAR PV
SOLAR STIRLING ENGINES
MICROHYDRO POWER GENERATION
FRESH WATER SUPPLY FROM SPRING DEVELOPMENT
COMPOSTING TOILETS
GAS GENERATOR BACKUP CAPABILITY

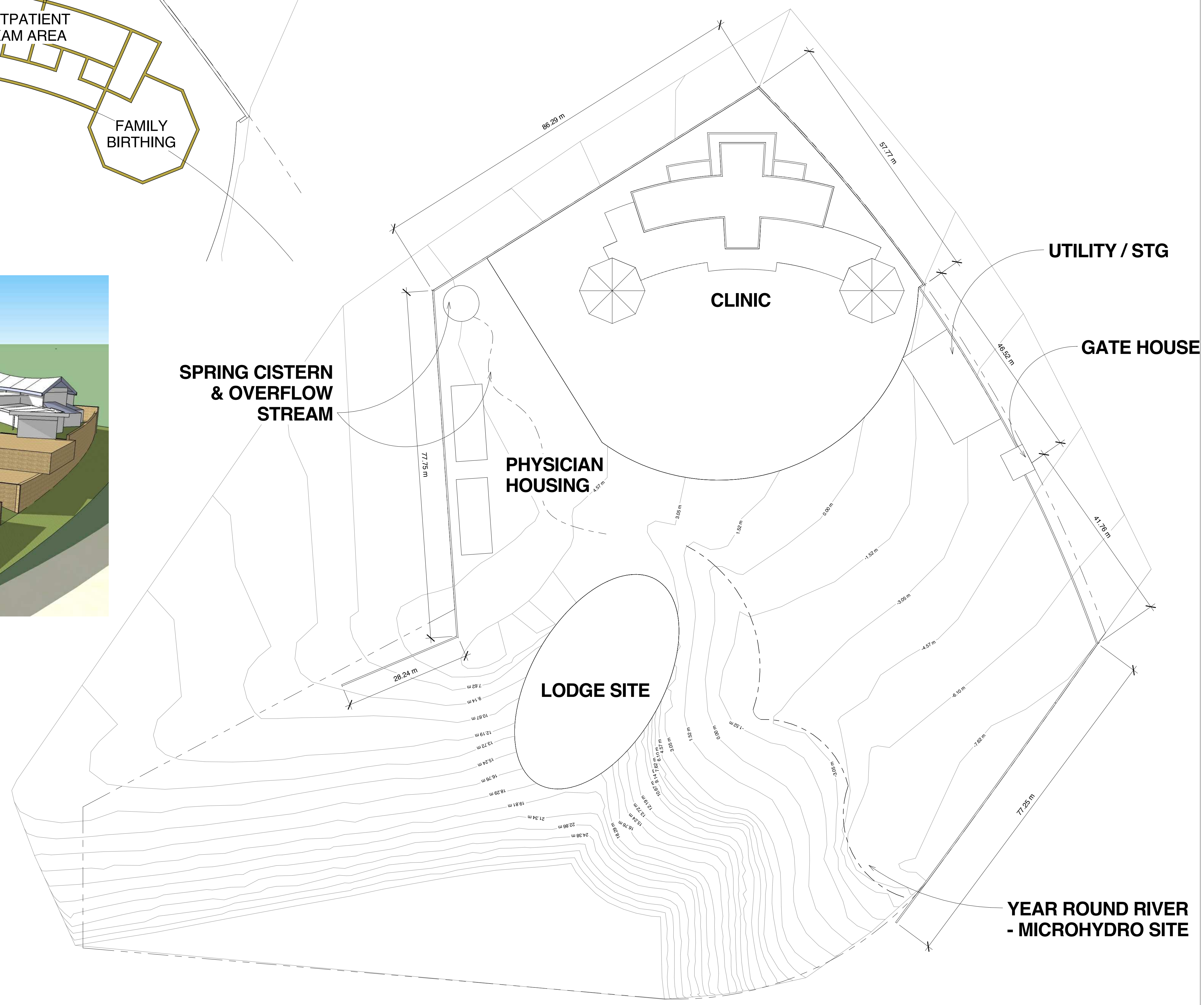

1 SITE PLAN
1:480

